

JAMIA HAMDARD
HAMDARD NAGAR, NEW DELHI-110062
NOTICE INVITING TENDER

Date: 17/09/2021

Jamia Hamdard invites sealed items rate Tenders in two bids system (Technical & Financial Bid) from Registered Contractors/Agencies at Govt. /Semi Govt. / State Govt. Departments./ Universities/Reputed Higher Education Institutions. The Tender documents and other details are available on the website: www.jamiahamdard.edu. Last date of submission of the Tender 01/10/2021 up to 3.00 PM.

The bidders are also advised to visit site to satisfy themselves before submitting the Technical bids. Bidders not fulfilling the Eligibility Criteria may be rejected.

NAME OF WORK:	CONSTRUCTION OF PORTA STRUCTURE FOR UNANI PHARMACY SALE COUNTER
ESTIMATED COST:	Rs. 5, 00,669.00
EARNEST MONEY:	Rs 10,000/-
TENDER COST:	Rs. 500/- (Non Refundable)
TIME PERIOD:	45 days.
PRE BID MEETING	27/09/2021 at 11:30 AM

The Tender duly filled should be dropped in the Tender Box kept in Purchase Section on or before 01/10/2021 upto 3.00 PM along with demand draft of Earnest money & Tender fee in sealed envelope clearly specifying the name of work. The D.Ds shall be in favour of "Jamia Hamdard" payable at New Delhi. The Tender shall be opened on 01/10/2021 at 3.30 PM by the tender committee in the presence of available interested parties in the Office of Executive Engineer and the Financial bid of the eligible parties will be opened on 06/10/2021 after due information to eligible parties.

In case, the required procedure is not followed, the tender can be rejected. Jamia Hamdard reserves the right to reject any or all tenders without assigning any reason whatsoever.

Sd/-
Registrar

Copy to:

1. System Analyst, Computer Center, to kindly upload the NIT with tender documents on the University website.
2. PA to Finance Officer for kind information.
3. Executive Engineer for kind information.
4. Medical Superintendent of Majeedia Unani Hospital for kind information.
5. Concerned Civil & Electrical Engineers for information & necessary action.
6. Notice board of Admin Block.

TENDER DOCUMENT

FOR

CONSTRUCTION OF PORTA STRUCTURE FOR
UNANI PHARMACY SALE COUNTER AT
MAJEEDIA UNANI HOSPITAL

JAMIA HAMDARD
HAMDARD NAGAR, NEW DELHI-62

(1) SCOPE OF WORK

- a. CONSTRUCTION OF PORTA STRUCTURE FOR UNANI PHARMACY SALE COUNTER
- b. All items as per specifications of BOQ (Civil & Electrical).

(2) ELIGIBILITY CRITERIA

- The agency must have completed 3 similar works in Govt. /Semi Govt. / State Govt. Departments. /Universities/Reputed Higher Education Institutions.

Copy of work /purchase order or contract and Completion Certificate/ satisfactory report from Client, duly attested by the bidder should be enclosed along with the Technical Bid.

- The bidder should be a single Company. No consortium is allowed.
- The firm should have average annual financial turnover of at least Rs. 25 lakhs during the preceding last 3 consecutive financial years. Copies of the audited balance sheet of the bidder for the last three financial years, details of Permanent Account Number and ITR (Income Tax Return) for last 3 financial years must be attached by the Bidder.
- The Bidders must have GST, PAN No., ESI, EPFO and company registration.
- The bidders must have their company/firm website.

(3) SUBMISSION OF BIDS

1. Submission of Tender: Tenders should be submitted in two Parts i.e. “Technical bid” (Part-A) and “Price bid” (Part-B) in two separate sealed envelopes. Both the parts should be further put in a single sealed envelope super-scribing NIT No. & name of work, due date for opening, bidder’s name & address. The tender duly filled should be dropped in the tender box kept in the Purchase Section; it should not be handed over to any employee of the Jamia Hamdard. No tender shall be accepted later than the time schedule specified above. Any clarifications/amendments/corrigenda etc., to NIT before last date of submission of bid will only be available on our website: www.jamiahamdard.edu. Therefore bidders are advised to keep visiting our website.

Technical Bid (Part-A):

In this bid, the bidder shall submit the following:

- a. Covering letter on Company’s Letter head

- b. Bio data of company (Company profile, organizational setup, credentials, list of plant, machinery & tools in his possession).
- c. DDs of Earnest Money Deposit & Tender Fee.
- d. Copies of GST no., PAN no., ESI, EPFO & company registration etc.
- e. Company's financial performance documents (Audited balance sheet, and profit and loss statement)
- f. Copies of work orders for similar nature of works of at least one contract of 80% value of estimated cost of works or two contracts of similar nature of works of 60% value of estimated cost of works or three contracts of similar natures of works of 40% value of estimated cost of works in the last 3 years.
- g. Entire NIT (except Price bid) duly signed & stamped by the bidder.
- h. Experience of having successfully completed works during the last 3 years ending last day of the month previous to the one in which applications are invited.
- i. Average annual financial turn over on said work should be at least 25 lakhs of the estimated cost during the last 3 financial years. Documents in support should be attached.

Note

1. Completion certificate submitted should be by an officer not below the rank of Executive Engineer.
2. All documents submitted by the bidder should be self-attested along with stamp

Price Bid (Part-B):

- i. BOQ of Civil & Electrical works is cited on **Annexure "X"**

In this bid, the related works' bidders are required to quote his item rates in the above said attached BOQ in accordance with the scope of works, terms & conditions & technical specifications enclosed. The rates/price quoted by contractor should be all inclusive i.e. should include all material cost, labour, services, plant/machinery/tools & tackles, ladders & scaffolding required for work, freight, Insurance, Octroi, Govt. duties & levies, GST, Service Tax, Sales Tax etc.), transport/cartage of materials/labour and all other expenses not specifically mentioned but reasonably implied. Nothing over and above these rates shall be payable to contractor. Further nothing extra in rates will be considered for any variations in tender quantities or due to any site difficulties. It is mandatory for bidder to quote all items rate as asked for in the BOQ/ PRICE schedule. Failure in not filling some item rates will lead to rejection of tender. The bidders should quote unconditional rates, neatly written without any overwriting and all pages should be duly signed & stamped

4 GENERAL TERMS & CONDITIONS

- I. **Earnest Money:** An earnest money of **Rs. 10,000.00** has to be enclosed along with the Bid. The EMD shall only be in the form of Bank Draft in favour of "Jamia Hamdard" payable "New Delhi". No Cheques/Cash shall be accepted as EMD. The refund of EMD to the technically disqualified shall be made within 20 days from the date of opening of price bid. The EMD of the successful lowest bidder (L1) shall be held back and will be released after completion of the works and site clearance. **As per Rule 170 of GFR--- "Micro and Small Enterprises (MSEs) as defined in**

MSE Procurement Policy issued by Department of Micro, Small and Medium Enterprises (MSME)” are exempt from submission of EMD.

- II. **Validity of Tender:** Tender shall be valid for our acceptance without any change in rates and NIT conditions for a period of 90 days from the date of opening of price bid.
- III. **Escalation:** No escalation over and above items rates quoted by the bidder shall be paid during the execution of contract.
- IV. **Completion time:** The time shall be the essence of this contract and entire work as titled above is to be completed in all respects within a period of 45 Days from the date of issue of the work order. Any delay in completing the work for reasons attributable to the Contractor is liable for liquidated damages as per clause XIII of NIT. Under the force-majeure conditions or delay due to reasons beyond control of the contractor, Jamia Hamdard may grant suitable time extension without penalty for which the contractor has to request along with the justification/ reasons well in advance to Jamia Hamdard for approval without any prejudice to price escalation. No time extension request shall be considered after the expiry of completion period/contract. The decision of the Executive Engineer regarding Time extension will be final and binding on the contractor.
- V. The contractors shall quote the rates excluding GST which may be quoted separately and other applicable taxes shall be deducted as per GOI norms. Jamia Hamdard welfare Relief Fund will be deducted @ 0.25% of the amount of total bill claimed.
- VI. **Deviations:** No deviation from the stipulated terms and conditions will be allowed. Tender will be unconditional.
- VII. **Site Conditions:** Contractor shall acquaint himself fully with the site conditions and the working environment of Jamia Hamdard before quoting his rates. No Compensation on account of any site difficulties will be entertained, at a later date, after award of the work.
- VIII. **Before tendering, the Contractor shall visit and examine the site and satisfy himself as to the site conditions, the correct dimensions of the work and facilities. In case of any doubt, may be clarified from the office of the Engineer In-charge.**

Correspondence: All the correspondence in respect of tender/award of work shall be made to Executive Engineer

- IX. **Terms of Payment:** The payment shall be made on submission of the bills in proper format by the contractor after due certification by the engineer responsible for supervision of the work. Contractor can submit two interim or running bills and one final bill after completion of work for claiming payment based on actual quantities of items of work executed as per BOQ and Engineer's instructions. 5% deductions will be made towards the security deposit from each running bill. The security deposit shall only be refunded after expiry of the defect & liability period of 6 months.
- X. **Labour Laws:** The contractor will abide by all the rules and regulations related to labour laws, accident, workmen compensation act, workmen insurance etc. This will be the sole responsibility of the contractor. Jamia Hamdard will not be a party at any stage in any of the disputes relating to the above. In case, Jamia Hamdard has to bear any expenditure due to non-conformance of the above provisions by the contractor, the same will be recovered from contractor's bills.
- XI. Rules governing the Contractor's employees working in the Jamia Hamdard Premises: The contractor's employees working inside the Jamia Hamdard campus will abide by the Centre's rules & regulations for works inside the campus. Any damage to the Jamia Hamdard property due to

mishandling, carelessness on the contractor's or his workmen's part will be recoverable from the contractor's bills.

- XII. **Liquidated damages:** In case the work is delayed beyond the specified completion period for reasons attributable to the contractor, deductions on account of Liquidated damages @1/2% of the contract value per week will be deducted subject to a maximum of 5% of the contract value. However, during the delayed period, Jamia Hamdard also reserves the right to get some portion of work done by any other contractor at the risk and cost of the existing contractor and amount to that effect along with 10% overhead charges will be deductible from his bills/dues.
- XIII. **Extra or substituted item:** If any extra or substituted item appears in the work, contractor shall submit its rate analysis supported with documents which shall be approved by Engineering Department. Analysis of rates will be based on DSR 18 document of CPWD or based on market rates analysis for determining item rate and pay to contractor accordingly.
- XIV. **Defect Liability period:** Defect liability period shall be six months from the date of completion of work. Any defect arising in this period due to contractor's fault will be rectified by him at his own cost. Failure to do so, shall lead to forfeiture of security deposit.
- XV. **Security Deposit:** A security deposit equal to 5 % of the value of work will be deducted from Contractor's bills and shall be refunded after the completion of defect liability period of six months after ensuring successful performance of the system executed by the contractor.
- XVI. Contractor should depute a qualified supervisor dedicated for this work, who will monitor and coordinate the works from contractor's side and interact with the Jamia Hamdard Engineers, responsible for supervision of work, on regular basis.
- XVII. Contractor will take due permission for entry of all his workmen in Jamia Hamdard. No unauthorized person will be allowed to work inside.
- XVIII. The contractor will arrange all necessary materials, tools, equipment, access ladders & scaffolding, measuring instruments and working consumables etc. needed for execution of the works. Safe custody of all such material will be contractor's sole responsibility. No extra charges will be paid for the same. Watch and ward of all material till the system is taken over by Jamia Hamdard shall be the sole responsibility of the contractor and pilferage etc. shall be entirely to his account.
- XIX. During execution of work, Engineer can make minor changes in the scope of work as per site conditions or other reasons. Contractor will have no extra claim in his rates for the same.
- XX. If during the execution of works, any damage is caused to Jamia Hamdard property by contractor's/contractors' workers, contractor will duly make good the loss. Jamia Hamdard has the right to make suitable deduction from contractor's bills along with penalty, if contractor fails to make good the loss.
- XXI. During execution of work, the contractor/contractors should follow all standard norms of safety measures/precautions as per relevant IS codes and CPWD specifications to avoid accidents/damages to man, machines and buildings, at his own cost. Contractor will have his own arrangement to escort the labour to the nearest hospital for treatment in case any injury happens to any worker during execution of work.
- XXII. Manpower deployed by the contractor at our site for carrying out contract works is strictly prohibited being associated with any other works on the campus.
- XXIII. No material belonging to the contractor whether consumable or non-consumable should be brought inside the Jamia Hamdard campus without proper entry at the Main Gate nor any material should be taken out without proper gate pass issued by the authorized representatives of the Centre.

- XXIV. During execution of the work, contractor should dispose of waste material on regular basis and should keep the area of work properly cordoned off and neat and clean as far as possible. After completion of work, contractor should clear the site completely of all unwanted and junk material before submitting his final bill.
- XXV. Jamia Hamdard will provide electricity, if needed, the electrical energy meter will be provided by the contractor and necessary deduction will be made as per the actual consumption of electricity during execution of work. The contractor has to make his own arrangements for water.
- XXVI. Tender once submitted will remain with the Jamia Hamdard and will not be returned to the bidders.
- XXVII. **Termination of Contract:** The Jamia Hamdard reserve the right to terminate the contract on account of poor workmanship, failure to mobilize site within 15 days, non-compliance of specifications for the works, abnormal delay in progress of work, violation of any contract provisions by the contractor. In such case, contractor's EMD and security deposit deducted so far will be forfeited.
- XXVIII. The contract can also be terminated on the request of contractor. In such cases the contractor is liable to pay Liquidated damages @ 5% of tendered value besides forfeiture of EMD & security deposit recovered so far.
- XXIX. Any dispute arising out of this contract will be subjected to jurisdiction of New Delhi/Delhi.
- XXX. Tenders not complying with any of the provisions stated in this tender document are liable to be rejected. Jamia Hamdard also reserves the right to accept or reject any or all the tenders without assigning any reason and does not bind him-self to accept the lowest tender or split the work in two or three parts.
- XXXI. That in the event of any difference, or dispute arising between the parties to this Agreement for any reasons whatsoever relating to the contract, whether during the substance of this Agreement or their after, it has specifically been agreed that the party will endeavor to amicably resolve the difference, but in case if dispute or differences still remain unresolved, the same shall be referred to the sole Arbitrator appointed by the Vice Chancellor of Jamia Hamdard and the Arbitrator decision shall be final and binding upon the parties concerned.

(5) SPECIAL TERMS AND CONDITIONS

- I. Makes of Items to be used by contractor will be according to the list of approved makes given. No other makes will be used by the contractor.
- II. Contractor will first submit the sample of relevant make to Executive Engineer/Engineer in-charge for approval before procuring the material.
- III. Contractor will arrange proper necessary material at his own cost and will take all safety measures like safety belts, extra labour to hold ladders etc. If it is observed that work is proceeding without adequate safety precautions, work may be stopped by Engineer-in-charge and in such cases, contractor will be solely responsible for delay and its consequences thereof.

(6) TECHNICAL SPECIFICATIONS

- I. As per CPWD Specifications and attached BOQ.
- II. List of approved make of materials is attached at Annexure B.

(7) CHECK LIST

TO BE SUBMITTED ALONG WITH BID

The tenderers are requested to ensure the submission of the essential documents to avoid disqualification of the bid. However, the check list is not exhaustive and the tenderers are requested to go through to NIT & related documents carefully and completely for fulfillments of tenderers requirement.

S. No.	Enclosures	Submitted
1.	Cost of tender document	
2.	EMD	
3.	Similar works order	
4.	Annual turnover certificate for the last three years with certification from practicing chartered accountant	
5.	Copy of registration letter	
6.	Signature with stamp in all pages of tender documents.	
7.	Bank account detail	
8.	E-mail address	
9.	Address for communication	
10.	Phone no, Mobile no, Landline no.	

Signature of the Tenderers

ANNEXURE-"B"

(8) LIST OF APPROVED MAKES (Civil Works)

1.	Ordinary Portland Cement	L&T, Ultra Tech, ACC, or other brands approved by the Engineer in-charge
2.	Steel Reinforcement Bars	TISCO, SAIL, RINL, Rathi udyog Ltd.
3.	Structural Steel Sections	TISCO, SAIL RINL, Supreme....
4.	Stone Aggregate (Blue/Black)	Sohna, Pali or other Approved
5.	Water proof Shuttering	Century, Green, Duro/Haryana Plywood
6.	Vitrified flooring and wall tiles	Kajaria, Orient, Somany, or equivalent as approved by the Engineer in-charge.
7.	Exterior Paint	Apex (Asian), weather shield (ICI DULUX) Shalimar or equivalent as approved by the Engineer in-charge.
8.	White Cement	Birla, JK Cement
9.	Waterproofing	Structural Water proofing Co. Dr. Fixit, Overseas Water Proofing
10.	Silicon Sealants	Dow Corning.GE
11.	Glass and mirror	Saint Gobain/Guardian/Asahi
12.	The Adhesives	Weber, Lafarge, Keisel, Balendura
13.	Expansion joint covers	CS, Inpro
14.	Glass	Saint Gobain, Guardian, Glaverbel,
15.	Gypsum board	Gyp pro, Lafarge or equivalent.
16.	Calcium silicate false ceiling	Armstrong or equivalent.
17.	CPVC pipes	Astral, Supreme or equivalent.
18.	S.S. sink	Neelkhant or equivalent.
19.	Aluminum	Jindal Or equivalent
20.	Commercial board and ply	Bhutan/Century/Greenlam, ISI approved brand or equivalent as approved by Engineer In-charge.
21.	Chequered Tiles and interlocking Paver Block, Kerb Stone	Hindustan, Modern, KGS, Nitco, or equivalent as approved by the Engineer in-charge.
22.	MDF Board	Century/Greenlam or equivalent

LIST OF APPROVED MAKE FOR ELECTRICAL WORKS

SPECIFICATION OF MATERIAL

S. No.	Particulars	Make
1.	Cable / Wire	Havells/ Polycab / Finolex/RR Kabel
2.	LED Light / LED Tube Light	Crompton Greaves / Havells / Philips
3.	MCB/Isolator /MCCB	ABB/ L&T/Havells
4.	Distribution Box	ABB/ L&T/Havells
5.	PVC conduits/ casing capping	Setia/Plasoduct/AKG
6.	Exhaust Fan / Wall Fan / Ceiling Fan	Crompton Greaves / Havells
7.	Switch / Socket	Anchor Roma / Havells

(Signature of bidder)

ANNEXURE X

CONSTRUCTION OF PORTA STRUCTURE FOR UNANI PHARMACY SALE COUNTER AT MAJEEDIA UNANI HOSPITAL

Bill of Quantities of Civil works

(A) Porta Structure & Civil Work					
S.No	DESCRIPTION	UNIT	QTY	RATE	AMOUNT
1	Earth work in excavation by mechanical means (Hydraulic excavator)/manual means over areas (exceeding 30 cm in depth, 1.5 m in width as well as 10 sqm on plan) including getting out and disposal of excavated earth lead upto 50 m and lift upto 1.5 m, as directed by Engineer-in-charge. All kinds of soil	cum.	6.00		
2	Filling available excavated earth (excluding rock) in trenches, plinth, sides of foundations etc. in layers not exceeding 20cm in depth, consolidating each deposited layer by ramming and watering, lead up to 50 m and lift upto 1.5 m.	cum.	6.00		
3	Providing and laying in position cement concrete of specified grade excluding the cost of centering and shuttering - All work up to plinth level : (foundation & under floor)				
	1:4:8 (1 Cement : 4 coarse sand (zone-III) : 8 graded stone aggregate 40 mm nominal size	cum	3.50		
4	Providing and laying damp-proof course 40mm thick with cement concrete 1:2:4 (1 cement : 2 coarse sand (zone-III): 4 graded stone aggregate 12.5mm nominal size)	sqm	2.10		
5	Brick work with common burnt clay F.P.S. (non modular) bricks of class designation 7.5 in foundation and plinth in:				
	Cement mortar 1:6 (1 cement : 6 coarse sand)	cum	2.00		
6	Brick work with common burnt clay F.P.S. (non modular) bricks of class designation 7.5 in superstructure above plinth level up to floor V level in all shapes and sizes in : Cement mortar 1:6 (1 cement : 6 coarse sand)	cum	2.50		
7	12 mm cement plaster of mix : 1:6 (1 cement: 6 fine sand)	sqm	15.00		
8	15 mm cement plaster on the rough side of single or half brick wall of mix 1:6 (1 cement: 6 fine sand)	sqm	20.00		
9	Wall painting with acrylic emulsion paint of approved brand and manufacture to give an even shade : Two or more coats on new work	sqm	50.00		
10	Providing and applying white cement based putty of average thickness 1 mm, of approved brand and manufacturer, over the plastered wall surface to prepare the surface even and smooth complete	Sqm	70.00		

11	Painting with synthetic enamel paint of approved brand and manufacture to give an even shade : Two or more coats on new work	sqm	10.00		
12	Finishing walls with Premium Acrylic Smooth exterior paint with Silicone additives of required shade: New work (Two or more coats applied @ 1.43 ltr/10 sqm over and including priming coat of exterior primer applied @ 2.20 kg/10 sqm)	sqm	30.00		
13	Providing and laying vitrified floor tiles in different sizes (thickness to be specified by the manufacturer) with water absorption less than 0.08% and conforming to IS: 15622, of approved make, in all colours and shades, laid on 20mm thick cement mortar 1:4 (1 cement: 4 coarse sand), jointing with grey cement slurry @ 3.3 kg/ sqm including grouting the joints with white cement and matching pigments etc., complete. Size of Tile 600x600 mm	sqm	23.50		
14	Cement concrete flooring 1:2:4 (1 cement : 2 coarse sand : 4 graded stone aggregate) finished with a floating coat of neat cement, including cement slurry, but excluding the cost of nosing of steps etc. complete. 40 mm thick with 20 mm nominal size stone aggregate	sqm	3.00		
15	Making plinth protection 50mm thick of cement concrete 1:3:6 (1 cement : 3 coarse sand : 6 graded stone aggregate 20 mm nominal size) over 75mm thick bed of dry brick ballast 40 mm nominal size, well rammed and consolidated and grouted with fine sand, including necessary excavation, levelling & dressing & finishing the top smooth.	sqm	5.00		
16	Providing and fixing tiled false ceiling of specified materials of size 595x595 mm in true horizontal level, suspended on inter locking metal grid of hot dipped galvanized steel sections (galvanized @ 120 grams/ sqm, both side inclusive) consisting of main "T" runner with suitably spaced joints to get required length and of size 24x38 mm made from 0.30 mm thick (minimum) sheet, spaced at 1200 mm center to center and cross "T" of size 24x25 mm made of 0.30 mm thick (minimum) sheet, 1200 mm long spaced between main "T" at 600 mm center to center to form a grid of 1200x600 mm and secondary cross "T" of length 600 mm and size 24x25 mm made of 0.30 mm thick (minimum) sheet to be interlocked at middle of the 1200x600 mm panel to form grids of 600x600 mm and wall angle of size 24x24x0.3 mm and laying false ceiling tiles of approved texture in the grid including, required cutting/making, opening for services like diffusers, grills, light fittings, fixtures, smoke detectors etc. Main "T" runners to be suspended from ceiling using GI slotted cleats of size 27 x 37 x 25 x1.6 mm fixed to ceiling with 12.5 mm dia and 50 mm long dash fasteners, 4 mm GI adjustable rods with galvanised butterfly level clips of size 85 x 30 x 0.8 mm spaced at 1200 mm center to center along main T, bottom	sqm	21.00		

	exposed width of 24 mm of all Tsections shall be pre-painted with polyester paint, all complete for all heights as per ecifications, drawings and as directed by Engineer-in-charge. 12.5 mm thick square edge PVC Laminated Gypsum Tile of size 595x595 mm, made of Gypsum plasterboard, manufactured from natural gypsum as per IS 2095 part I and laminated with white 0.16mm thick fire retardant PVC film on the face side and 12micron metalized polyester on the back side with all edges sealed with the face side PVC film which goes around and wraps the edges and is bonded to the edges and the back side metalized polyester film so as to make the tile a completely sealed unit.				
17	Supplying and fixing rolling shutters of approved make, made of required size M.S. laths, interlocked together through their entire length and jointed together at the end by end locks, mounted on specially designed pipe shaft with brackets, side guides and arrangements for inside and outside locking with push and pull operation complete, including the cost of providing and fixing necessary 27.5 cm long wire springs manufactured from high tensile steel wire of adequate strength conforming to IS: 4454 - part 1 and M.S. top cover of required thickness for rolling shutters. 80x1.25 mm M.S. laths with 1.25 mm thick top cover	sqm	6.69		
18	Providing and fixing ball bearing for rolling shutters.	each	2.00		
19	Filling & laying of raised area for proposed porta structure with available construction waste material within the campus premises as per the instruction of Engineer In-charge complete with all including labour and compaction.	cum	10.00		
20	Walls - The walls shall be made out of sandwich panel made of two fiber reinforced cement facing sheets on either sides of a lightweight concrete core. The core is made from a mix of Portland cement and binders. These fiber cement boards shall be of thickness up to 5 mm. The core shall compose of Portland cement and a mix of silaceous & micaceous material. These panels shall have unique tongue and Groove locking arrangements for jointing. The overall walls shall be 75mm thick. Make:Everest Rapicon Wall.	sqm	15.32		
21	Roofing Providing and fixing on the roof shall be covered by Hi quality PPGI colour coated profiled sheets 0.50mm. Make: Asian/Essar/Equivalent. For extra precautions every hole will be seald with silicon (rubberized chemical compound).	kg	200.00		
22	Bubble Sheet insulation of roof Supply and installation of insulation of bubble sheet of 12mm.	sqmt	25.00		

23	Structural framing for wall & roof construction Steel Structure – the steel structure shall be made out of MS tubular sections (SHS & RHS) with truss, purling and portals. The steel structure shall be coated with rust preventive red oxide primer. Make: Best/Hi-tech/Surya/Equivalent. Size of section 100x100x4mm, 40x80x3mm, 60x40x2.5mm	kg	300.00		
24	Providing & fixing 4mm thick ACP sheet of approved color and make, the sheet will be fixed on existing MS tubes complete as required	Sqft	80.00		
	Total (A)				

(B) External Development & re-routing of existing services

S.No	DESCRIPTION	UNIT	QTY	RATE	AMOUNT
1	Earth work in surface excavation not exceeding 30 cm in depth but exceeding 1.5 m in width as well as 10 sqm on plan including getting out and disposal of excavated earth upto 50 m and lift upto 1.5 m, as directed by Engineer-in-Charge: All kinds of soil	sqm	12.00		
2	Providing and laying in position cement concrete of specified grade excluding the cost of centering and shuttering - All work up to plinth level :				
	1:4:8 (1 Cement : 4 coarse sand (zone-III) : 8 graded stone aggregate 40 mm nominal size	cum	1.00		
3	Providing and laying at or near ground level factory made kerb stone of M-25 grade cement concrete in position to the required line, level and curvature, jointed with cement mortar 1:3 (1 cement: 3 coarse sand), including making joints with or without grooves (thickness of joints except at sharp curve shall not to more than 5mm), including making drainage opening wherever required complete etc. as per direction of Engineer-in-charge (length of finished kerb edging shall be measured for payment). (Precast C.C. kerb stone shall be approved by Engineer-in-charge).	cum	0.65		
4	Providing and laying 60mm thick factory made cement concrete interlocking paver block of M -30 grade made by block making machine with strong vibratory compaction, of approved size, design & shape, laid in required colour and pattern over and including 50mm thick compacted bed of coarse sand, filling the joints with line sand etc. all complete as per the direction of Engineer-in-charge.	sqm	12.00		
5	Re-routing of existing services like MS fire pipe, chamber, rainwater pipes, drainage, manholes, STP waste water line etc complete as required	Job	1.00		
	Total (B)				

(C) Aluminium Work

S.No	DESCRIPTION	UNIT	QTY	RATE	AMOUNT
------	-------------	------	-----	------	--------

1	Providing and fixing aluminium die cast body tubular type universal hydraulic door closer (having brand logo with ISI, IS : 3564, embossed on the body, door weight upto 35 kg and door width upto 700 mm), with necessary accessories and screws etc. complete.	1.00	each		
2	Providing and fixing the powdered coated aluminum partitions with extruded built up standard tubular sections of size 2.5"x1.5" of 16 gauge, fixing with dash fasteners of required dia and size, including necessary filling up the gaps at junctions i.e at top ,bottom and sides with required EPDM rubber/neoprene gasket etc .Aluminium sections shall be smooth ,rust free, straight, mitered and jointed mechanically wherever required including cleat angle, Aluminium snap beading for glazing /paneling ,c.p brass/stainless steel screws, all complete as per the direction of Engineer in charge. The partition having the 5mm thick plain glass on top of the wooden cash counter with two semicircle openings as per drawing complete as required.	sqft	45.00		
3	Providing and fixing the aluminum powdered coated Door with extruded built up standard tubular sections of size top, vertical and middle 3.25"x1.75" of 16 gauge, fixing with dash fasteners of required dia and size, including necessary filling up the gaps at junctions i.e at top ,bottom and sides with required EPDM rubber/neoprene gasket etc .Aluminium sections shall be smooth ,rust free, straight, mitered and jointed mechanically wherever required including cleat angle, Aluminium snap beading for glazing /paneling ,c.p brass/stainless steel screws, all complete as per the direction of Engineer in charge. The door having the 5mm thick glass on top and on bottom 12 mm thick particle board of approved color including aluminium tower bolt, handle, lock, door stopper complete as required.	Sqft	21.00		
4	Providing & fixing aluminium powdered coated Windows with standard sections of frames & shutters with handles, 5mm thick plain glass & other accessories complete as required. Size of window as per drawing.	sqft	21.52		
	Total (C)				

(D) Storage Wooden Cabinets & Cash/Sale Counter

SNo	DESCRIPTION	UNIT	QTY	RATE	AMOUNT
1	Providing ,fabricating and fixing in position the wooden cupboard of apprx size 14'3"x7'x20" which is made out of 19 mm thick commercial board with 6 mm thick commercial ply on back. The cupboard having the shutters and drawers upto the height of 3' and above that three open partitions complete as per sketch. all exposed surface of the cupboard pasted with 1mm thick laminate of approved color and brand, complete as per requirement including two or more coats of anti termite solution, PVC	sqft	100.00		

	edge beading, telescopic channels, locks, magnetic catchers, piano hinges/albihari lock, fancy handle, and hardware , painting & polishing etc.complete				
2	Providing ,fabricating and fixing in position the wooden cahs/sale counter of apprx size 11'3"x2'x3' high which is made out of 19 mm thick commercial board. The counter having the provision of CPU, keyboard & two drawers & one shutter on right hand side and on left hand side two drawers & one shutter. All exposed surface of the counter pasted with 1mm thick laminate of approved color and make, complete as per requirement including two or more coats of anti termite solution, telescopic channel, teak margin, PVC beading, locks, magnetic catcher, piano hinges/albihari lock, fancy handle, and hardware , painting & polishing complete	sqft	34.00		
	Total (D)				
	Total Civil Works (A+B+C+D)				

(Signature of bidder)

**CONSTRUCTION OF PORTA STRUCTURE FOR UNANI PHARMACY SALE COUNTER AT
MAJEEDIA UNANI HOSPITAL**

Bill of Quantities of Electrical works

S.No.	Particular	Qty	Unit	Rate	Amount
1	DSR-2018/1.10.1 Wiring for light point/ fan point/ exhaust fan point/ call bell point with 1.5 sq.mm FRLS PVC insulated copper conductor single core cable in surface / recessed medium class PVC conduit, with modular switch, modular plate, suitable GI box and earthing the point with 1.5 sq.mm FRLS PVC insulated copper conductor single core cable etc. as required (Make: Havells/ Polycab / Finolex)	5	Nos.		
2	DSR-2018/1.14 Supplying and fixing of following sub-main circuit wiring with PVC insulated copper conductor alongwith loop earthing single core cable and laying in PVC Conduit/casing, capping on urface/recessed etc. as required. (Make: Havells/ Polycab / Finolex/RR kabel)				
a	2 × 2.5sq. mm + 1 × 2.5 sq. mm earth wire (1.14.2)	20	Rmt		
b	2 × 6.0sq. mm + 1 × 6.0 sq. mm earth wire (1.14.4)	30	Rmt		
3	DSR-2018/1.31 Supplying and fixing suitable size GI box with modular plate and cover in front on surface or in recess, including providing and fixing 3 pin 5/6 A modular socket outlet and 5/6 A modular switch, connections etc. as required. (Make: Anchor Roma / Havells)	4	Nos.		
4	DSR-18/ 1.25 Supplying and fixing two module stepped type electronic fan regulator on the existing modular plate switch box including connections but excluding modular plate etc. as required (Make: Anchor Roma / Havells)	2	Nos.		
5	DSR-2018/2.10 Supplying and fixing 5 A to 32 A rating, 240/415 V, 10 kA, “C” curve, miniature circuit breaker suitable for inductive load of Single poles in the existing MCB DB complete with connections, testing and commissioning etc. as required.				
a	Single Pole MCB (2.10.1) (Make: ABB/ Hager / Havells)	3	Nos.		
6	DSR-2018/2.3.1 Supplying and fixing 6 way, double door, single pole and neutral, sheet steel, MCB distribution board, 240 V, on surface/ recess, complete with tinned copper bus bar, neutral bus bar, earth bar, din bar, interconnections, powder painted including earthing etc. as required. (But without MCB/RCCB/Isolator) (Make: ABB/ Hager / Havells)	1	Nos.		

7	Supply and Fixing of 40 A DP MCB complete with connection etc as required. (Make: ABB/ Hager / Havells)	1	nos.		
19	Supply installation, testing and commissioning of 48" Ceiling fan High Speed including wiring the down rods of standard length (upto 30 cm) with 1.5 sq. mm FRLS PVC insulated, copper conductor, single core cable etc. as required. Make: Crompton Greeves / Havells	2	Nos.		
8	Supply Installation, testing and commissioning of pre-wired, 20 W LED tube fitting complete with all accessories and tube/lamp etc. directly on ceiling/ wall, including connections with 1.5 sq. mm FRLS PVC insulated, copper conductor, single core cable and earthing etc. as required.of 20Watt LED Betton Tube light fitting complpete connection etc as required. (Make: Crompton/Havells/Phillips)	3	Nos.		
9	Supply and fixing of fan hook	2	Nos.		
		Total			

(Signature & Seal of the Contractor)

DRAWINGS

&

ROUGH SKETCHES

Proposed Ummah Med. Shop Cash/Sale
 Center (Majedda Ummah Halpi)
 Jame'a Hamdard

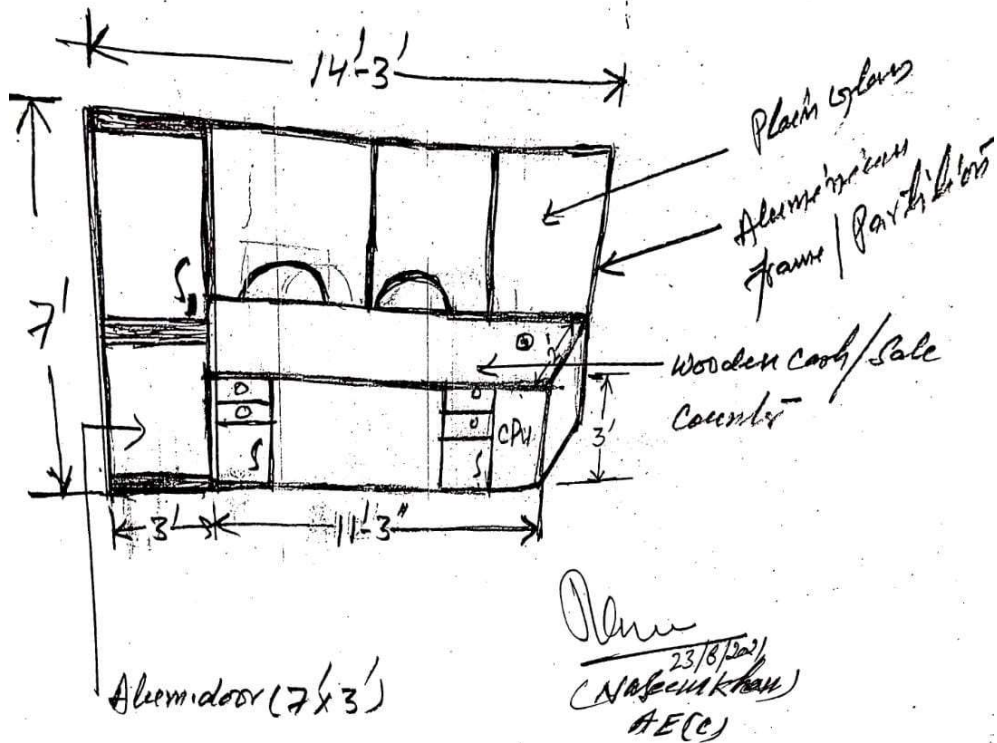

Plan
 23/8/2021
 (Naseem Khan)
 A/E (C)

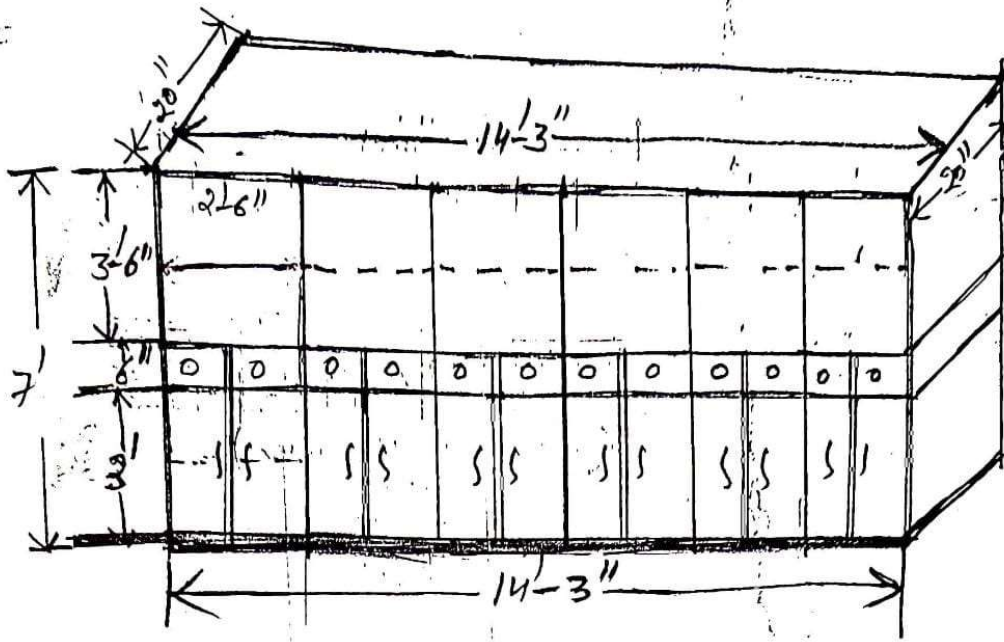

Women Med Storage cabinets

(Majeed's Women Hospital)
Jameel Handover

Nadeem

23/10/2021
(Nadeem Khan)

A. E. C.

Proposed unani
 Med. Shop (Maj'eedah Hosh)
 Janta Hamdard

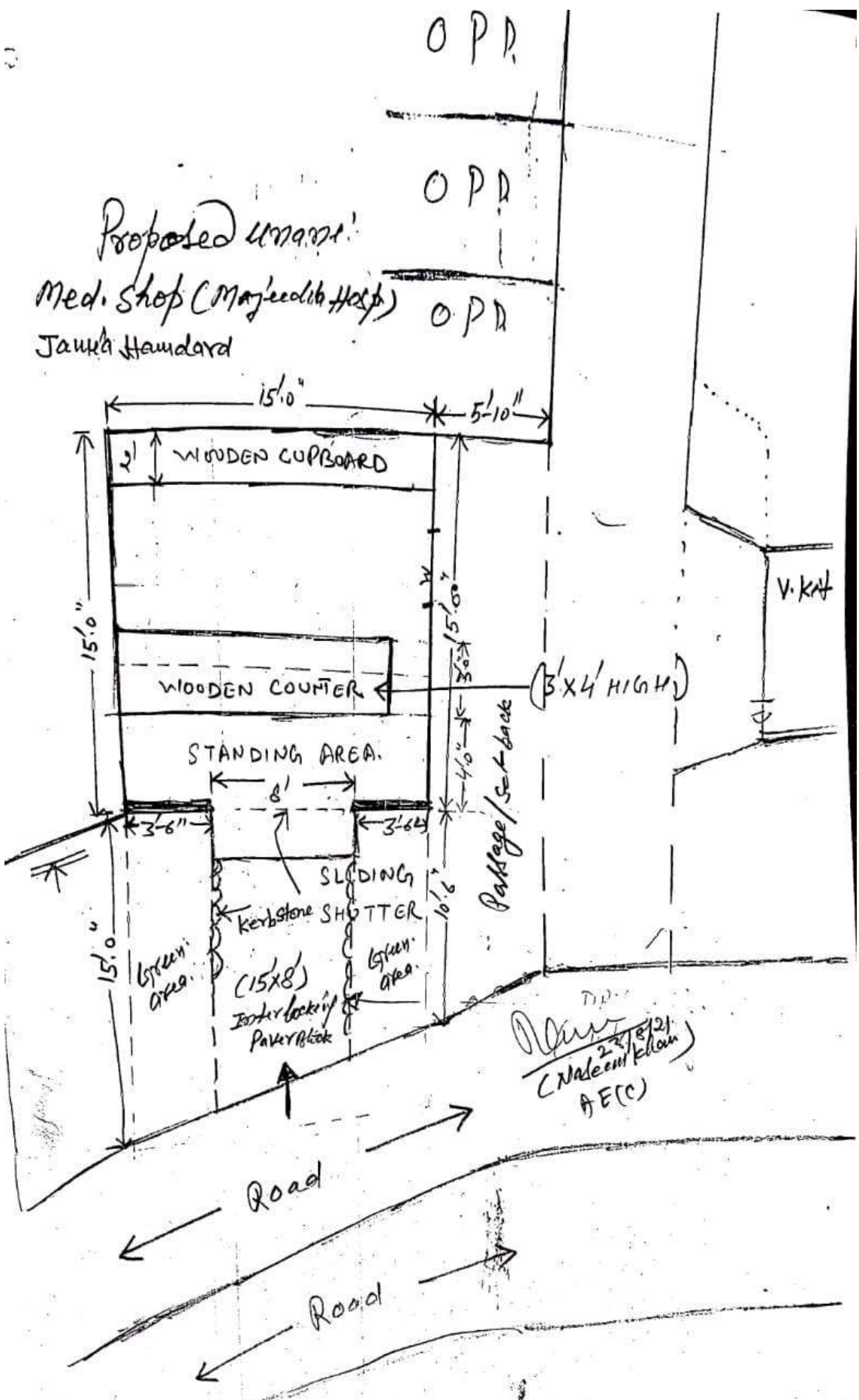

Summary of Cost

<u>S.N.</u>		<u>Amount</u>
1.	Civil Works	
2.	Electrical Works	
	<u>Total</u>	

(Signature of bidder)